

## USB 3.0 + Dual Mini DisplayPort™ MST Docking Station

- ✔ Support resolutions for:  
Single screen setup: up to 4K at 60Hz or  
Dual Screen setup: up to 1600p at 60Hz
- ✔ Provides two Mini DisplayPort™ 1.2 output ports
- ✔ Expands a USB 3.0 port to three USB 3.0 ports
- ✔ Gigabit Ethernet port (10/100/1000Mbps)
- ✔ DP++ HBR2 enabled Mini DisplayPort outputs
- ✔ Supports DP 1.2 Multi-Stream Transport (MST)



## Introduction

The SenseVision USB 3.0 + Dual Mini-DP MST Docking Station can easily connect to your Microsoft™ Surface Pro 2/3/4 Tablet or Laptop and enable connectivity to a full range of peripherals like keyboards, mice and storage devices. It has three built-in USB 3.0 ports, two MiniDisplayPor™ 1.2 outputs and one Gigabit Ethernet port. You can even extend the connections of the USB ports further to add more peripherals or USB devices. Featuring Multi Stream Transport technology, it supports dual screen setup with resolutions up to **2 x 2560x1600p 60Hz**.

### Dual Mode DisplayPort™ (DP++)

The MST Hub supports Dual Mode DisplayPort™ (DP++) which allows the use of DVI or HDMI™ Monitors via passive Adapters.



## Package contents

Before attempting to use this unit, please check the packaging and make sure the following items are contained in the shipping carton:

- USB 3.0 + Dual Mini DisplayPort™ MST Docking Station
- Power Supply
- Driver
- Quick install guide

### Uplinks:

- 1x Mini DP Male
- 1x USB 3.0 A Male
- 1x Power Adapter

### Outputs:

- 2x Mini DisplayPort™ 1.2 Female
- 3x USB 3.0 A Female
- 1x Gigabit Ethernet RJ45 Female

## Features

- Compliant with DisplayPort™ 1.2 specifications
- Supports main link rates of 5.4Gbps (HBR2), 2.7Gbps (HBR) and 1.62Gbps (RBR) from source
- Supports DP 1.2 Multi-Stream Transport (MST)
- Supported Max Resolutions: For Single Screen Setup: 3840x2160 @ 60Hz  
For Dual Screen Setup: 2 x 2560x1600 @ 60Hz
- Expands a USB 3.0 port to three USB 3.0 ports
- Gigabit Ethernet 10/100/1000 port
- Ethernet supports Wake-on-LAN technology, crossover detection.
- Power Adapter: 100-240VAC, 50/60Hz, operating 19.5W

LED INDICATOR

POWER

ETHERNET

Supports DP 1.2 Multi-Stream Transport (MST)



3 x USB 3.0

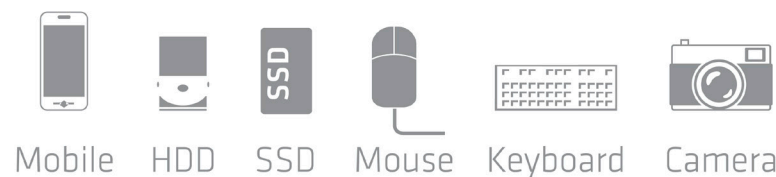

## Troubleshooting

### Here are the steps to solve possible problems.

Scenario: No video on any downstream monitor connected:

1. Check the LED to make sure Y-cable docking station has power. Use only the power adapter that was provided with Y-cable docking station.
2. Check that each downstream monitor is powered on.
3. Check the DisplayPort cable to be sure it is connected to the computer and Y-cable docking station.
4. Check the computer or graphics card user manual to confirm that DisplayPort 1.2 and a multi-stream video signal are supported.
5. Check the Windows Display Control Panel to confirm that the downstream monitors attached to the hub have been detected and enabled.

### Scenario: No video on one downstream monitors connected:

1. Y-cable docking station can support up to two monitors at 4K resolution.
2. Check the DisplayPort cable to be sure it is connected to Y-cable docking station and monitor.
3. If the monitor is a DVI or VGA monitor, check the DisplayPort cable to be sure it is connected

to . Check the other end of the cable to make sure the DisplayPort-to-DVI or DisplayPort-to-VGA adapter is properly connected to the DisplayPort cable and to the monitor.

4. If the monitor is a DVI or VGA monitor and the cable and adapter are properly attached, test the monitor, cable, and adapter with another computer.
5. Check the computer or graphics card user manual to confirm the number of multi-stream video signals that are supported and the maximum resolution.
6. Check the Windows Display Control Panel to confirm that the downstream monitors attached to Y-cable docking station have all been detected and enabled.
7. Check the monitor with no video to confirm the DisplayPort input has been selected.

### Scenario: Same image appears on all downstream ports:

1. Check the computer or graphics card user manual to confirm that DisplayPort 1.2 and multi-stream video signal are supported.
2. Check the Windows Display Control Panel to confirm that all downstream monitors are set for extended mode.
3. Update the video driver to the latest version available to enable the multi-stream functionality.

## Quick start guild

### 1 Connect to PC

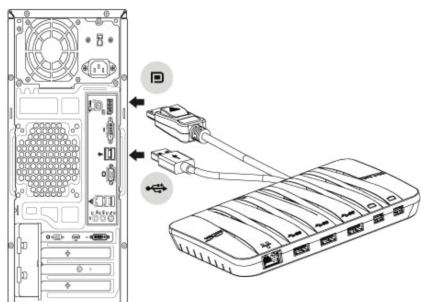

### 2 Front view

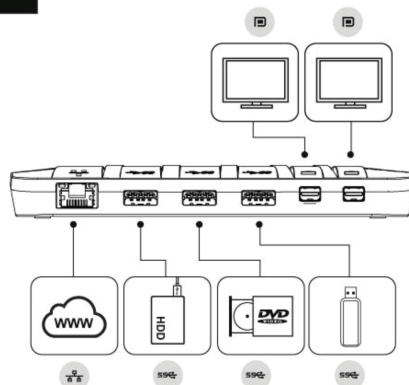

### 3 Back view

